

TIMBER SALE MAP



Douglas County Forestry Department
 9182 East Hughes Avenue
 P.O. Box 211
 Solon Springs, WI 54873
 Phone (715) 378-2219, Fax (715) 378-2807

TRACT NUMBER: 13-17

SALE NUMBER:

Prepared By: Justin Holmes Legal: Sec 32&33 T43N - R11W
 Sale Name: Last Minute Town: Wascott Topography: Flat
 Scale Method: Ticket Scale Acres: 83 Harvest Units: 2 Soils: Peat/Muck
 Contract Period: 2 Years Map Scale: 4" = 1 mile Season: Frozen Ground

-- See the Douglas County Timber Sale Contract and reverse side for terms and conditions. --

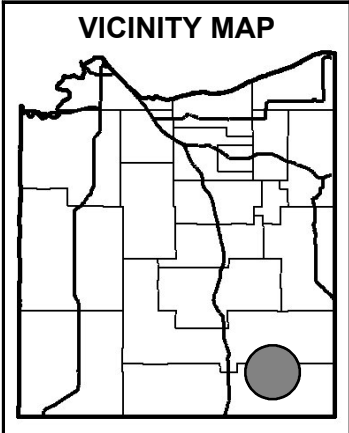

SPECIES, PRICE & ESTIMATED VOLUME INFORMATION

SPECIES	4" ROUNDWOOD (CORDS)	WHOLE-TREE (CORDS)	SAWLOGS (MBF)	MINIMUM TOTAL SPECIES PRICE
Tamarack	1,220	1,740	XXX	\$5,220.00
Mixed HW	140	190	XXX	\$570.00
TOTALS	1,360	1,930	XXX	\$5,790.00

The Tamarack volume contains approximately 76% Tamarack and 24% Black Spruce. The Mixed HW volume contains approximately 46% Red Maple, 23% White Spruce, 18% Scrub Oak, 9% Balsam Fir and 4% misc.

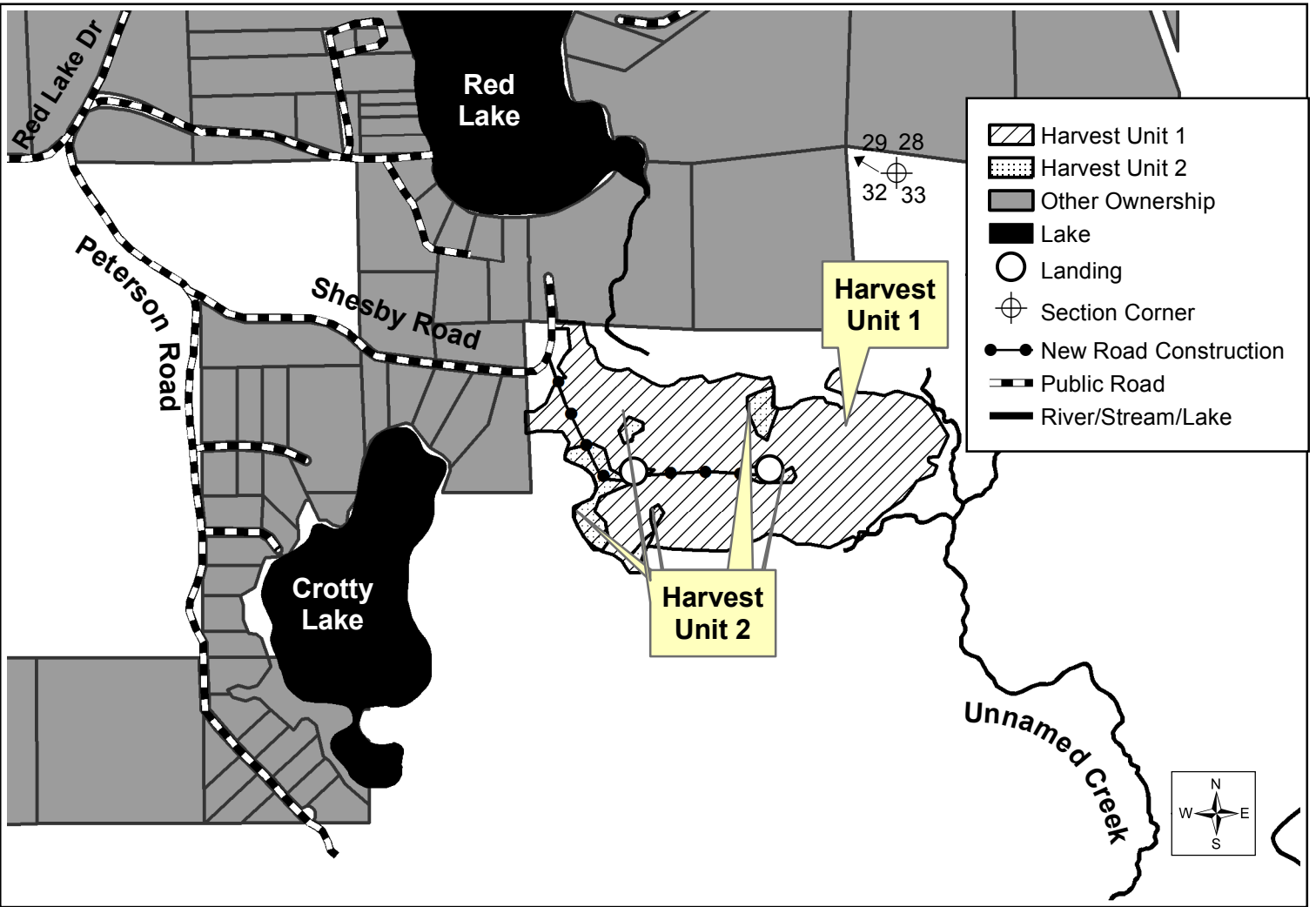

TRACT 13-17 (LAST MINUTE) – SUPPLEMENTAL REQUIREMENTS

The following terms and conditions supplement those provided in the Douglas County Timber Sale Contract:

A. PRESCRIPTION -

- Clear-cut harvest prescription with an estimated average residual basal area of 4ft².

B. SEASONAL RESTRICTIONS -

- All harvesting operations shall be limited to frozen ground conditions only.

C. TREES DESIGNATED FOR CUTTING -

- Fell all tamarack, red maple, white spruce, black spruce, balsam fir, and miscellaneous species stems; and all less than 14-inch DBH scrub oak and red oak stems. Skid and haul all felled stems that meet the product and utilization standards as per product bid.

D. TREES DESIGNATED FOR LEAVING -

- Reserve and leave undamaged all red pine, white pine, jack pine, cedar, yellow birch, and white birch stems; all 14-inch and greater DBH scrub oak and red oak stems.

E. HARVEST AND OPERATIONAL REQUIREMENTS -

- "Slashing Maintenance" is required.
- Operations shall minimize to the greatest extent possible any damage to advanced regeneration.
- Access road system may be utilized for product decking.
- Two landing locations are permitted as designated.

F. ACCESS AND ROADS -

- The total length of the access road system is approximately 2,500 feet.
- The entire 2,500 feet will require "Class 4" new construction.
- Significant portions will require freeze down before use.
- An "Earth Berm" shall be installed at a location designated by the Sale Administrator.

G. OTHER -

- The access road and landing locations requiring new construction are not marked in the field. The Sale Administrator will locate, identify, and flag these in during the pre-operations meeting.