

TIMBER SALE MAP



Douglas County Forestry Department
 9182 East Hughes Avenue
 P.O. Box 211
 Solon Springs, WI 54873
 Phone (715) 378-2219, Fax (715) 378-2807

TRACT NUMBER: 04-23

SALE NUMBER:

Prepared By: Jim Latvala (WDNR) Legal: Section 28 & 32, T44N - R15W
 Sale Name: Swedish Highway II Town: Dairyland Topography: Flat
 Scale Method: Ticket Scale Acres: 89 Harvest Units: 2 Soils: Silt Loam
 Contract Period: 2 Years Map Scale: 3" = 1 mile Season: Seasonal (see reverse)

-- See the Douglas County Timber Sale Contract and reverse side for terms and conditions. --

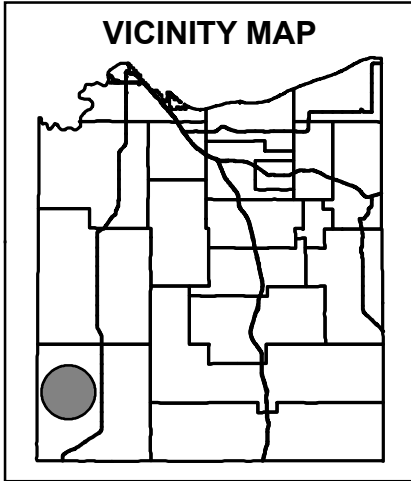

SPECIES, PRICE & ESTIMATED VOLUME INFORMATION				
SPECIES	4" ROUNDWOOD (CORDS)	WHOLE-TREE (CORDS)	SAWLOGS (MBF)	MINIMUM TOTAL SPECIES PRICE
Mixed HW	840	XXX	XXX	\$7,056.00
Mixed HW	XXX	XXX	111	\$6,216.00
TOTALS	840	XXX	111	\$13,272.00

The Mixed HW cord volume contains approximately 32% Aspen, 26% Red Oak, 14% White Birch, 10% Sugar Maple, 7% Balsam Fir, 6% Black Ash, 3% Basswood, 1% Red Maple, & 1% Misc. The Mixed HW (MBF) volume contains approximately 82% Red Oak, 17% Sugar Maple, & 1% Misc.

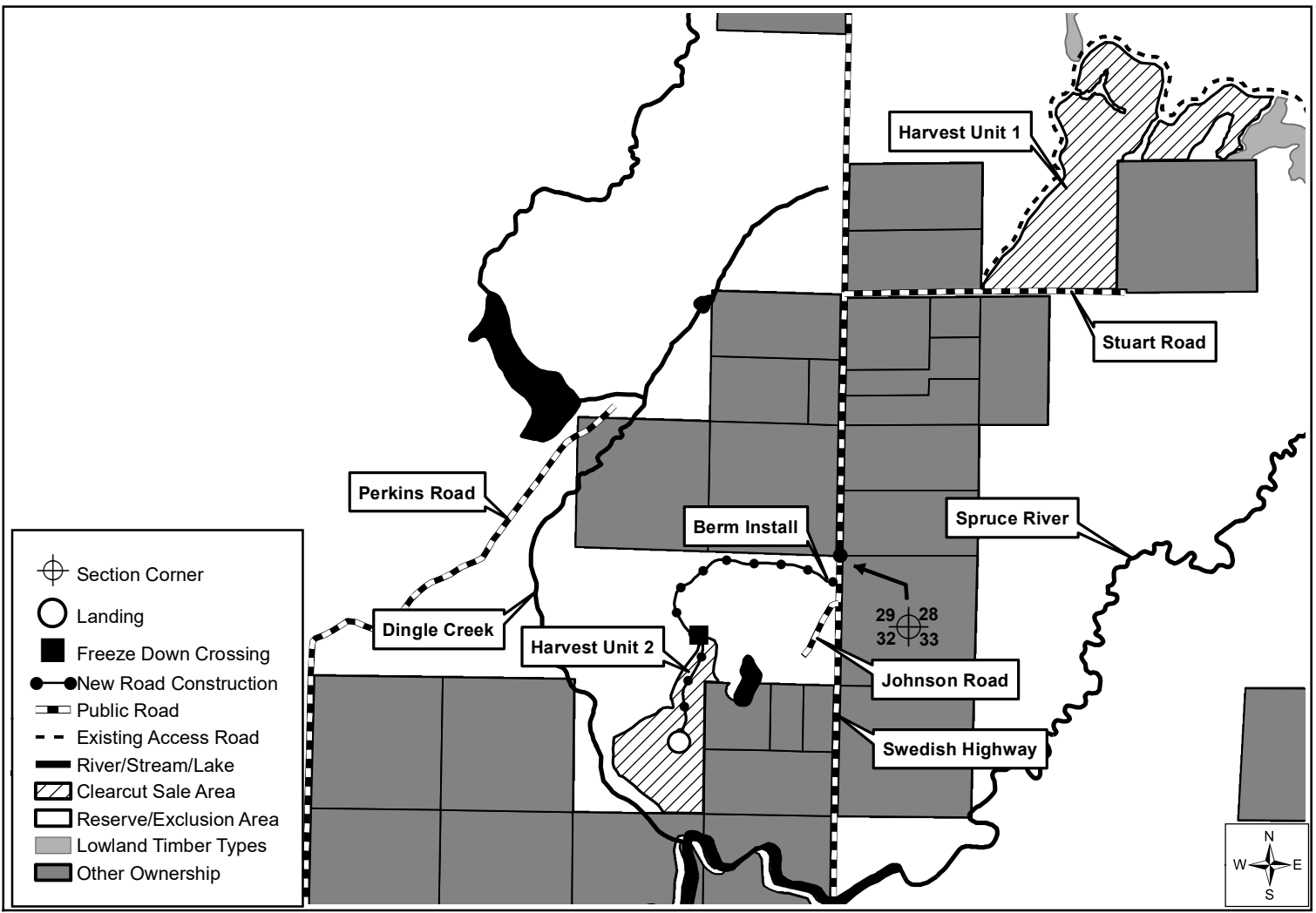

- Section Corner
- Landing
- Freeze Down Crossing
- New Road Construction
- Public Road
- Existing Access Road
- River/Stream/Lake
- Clearcut Sale Area
- Reserve/Exclusion Area
- Lowland Timber Types
- Other Ownership

