

# TIMBER SALE MAP



Douglas County Forestry Department  
 9182 East Hughes Avenue  
 P.O. Box 211  
 Solon Springs, WI 54873  
 Phone (715) 378-2219, Fax (715) 378-2807

**COPY**

TRACT NUMBER: 36-19

SALE NUMBER: US10

Prepared By: Jim Latvala (WDNR) <sup>Holmes</sup> Legal: Sec 4 & 5 T44N - R11W  
 Sale Name: Blue Ox Town: Gordon Topography: Flat  
 Scale Method: Ticket Scale Acres: 117 Harvest Units: 2 Soils: Sand  
 Contract Period: 2 Years Map Scale: 4" = 1 mile Season: All-Season

-- See the Douglas County Timber Sale Contract and reverse side for terms and conditions. --

## VICINITY MAP

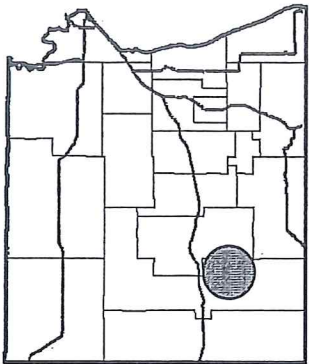

## SPECIES, PRICE & ESTIMATED VOLUME INFORMATION

SPECIES	4" ROUNDWOOD (CORDS)	WHOLE-TREE (CORDS)	SAWLOGS (MBF)	MINIMUM TOTAL SPECIES PRICE
Aspen	2,170	XXX	XXX	\$36,456.00
Red Pine	200	XXX	XXX	\$4,780.00
				\$165,240.00
<b>TOTALS</b>	<b>2,370</b>	<b>XXX</b>	<b>XXX</b>	<b>\$41,236.00</b>

The Aspen volume contains approximately 96% Aspen, 2% Scrub Oak, 1% White Birch & 1% Misc. The Red Pine volume contains approximately 95% Red Pine & 5% Jack Pine.

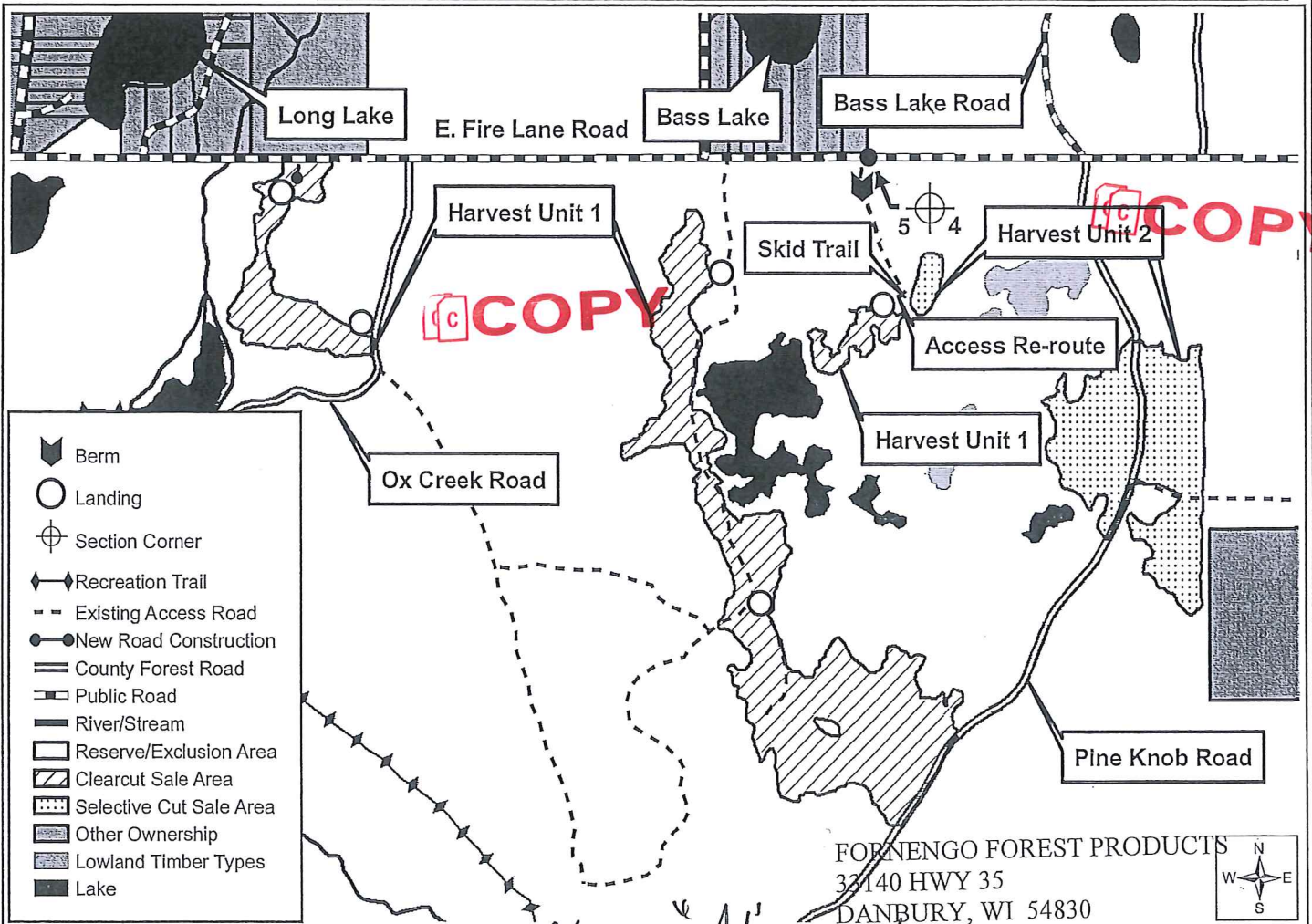

FORNENGO FOREST PRODUCTS  
 37140 HWY 35  
 DANBURY, WI 54830



*3 permits A 9/20*