

TIMBER SALE MAP



Douglas County Forestry Department
 9182 East Hughes Avenue
 P.O. Box 211
 Solon Springs, WI 54873
 Phone (715) 378-2219, Fax (715) 378-2807

TRACT NUMBER: **26-20**

SALE NUMBER:

Prepared By: Jim Latvala (WDNR) Legal: Sec 23 & 26 T46N - R14W
 Sale Name: Sprucetacular Town: Summit Topography: Flat
 Scale Method: Ticket Scale Acres: 89 Harvest Units: 2 Soils: Peat/Muck
 Contract Period: 3 Years Map Scale: 4" = 1 mile Season: Frozen Ground

-- See the Douglas County Timber Sale Contract and reverse side for terms and conditions. --

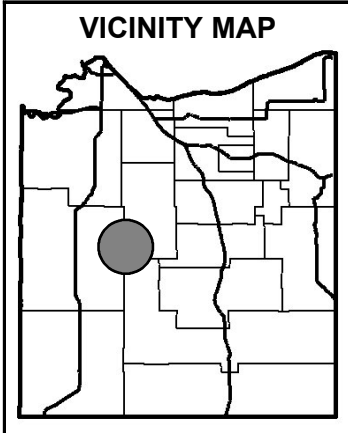

SPECIES, PRICE & ESTIMATED VOLUME INFORMATION				
SPECIES	4" ROUNDWOOD (CORDS)	WHOLE-TREE (CORDS)	SAWLOGS (MBF)	MINIMUM TOTAL SPECIES PRICE
Black Spruce	1,365	XXX	XXX	\$3,685.50
Aspen	1,100	XXX	XXX	\$15,290.00
TOTALS	2,465	XXX	XXX	\$18,975.50

The Black Spruce volume contains approximately 50% Black Spruce, 47% Tamarack, & 3% Balsam Fir. The Aspen volume contains approximately 86% Aspen, 8% White Birch, & 6% Red Maple.

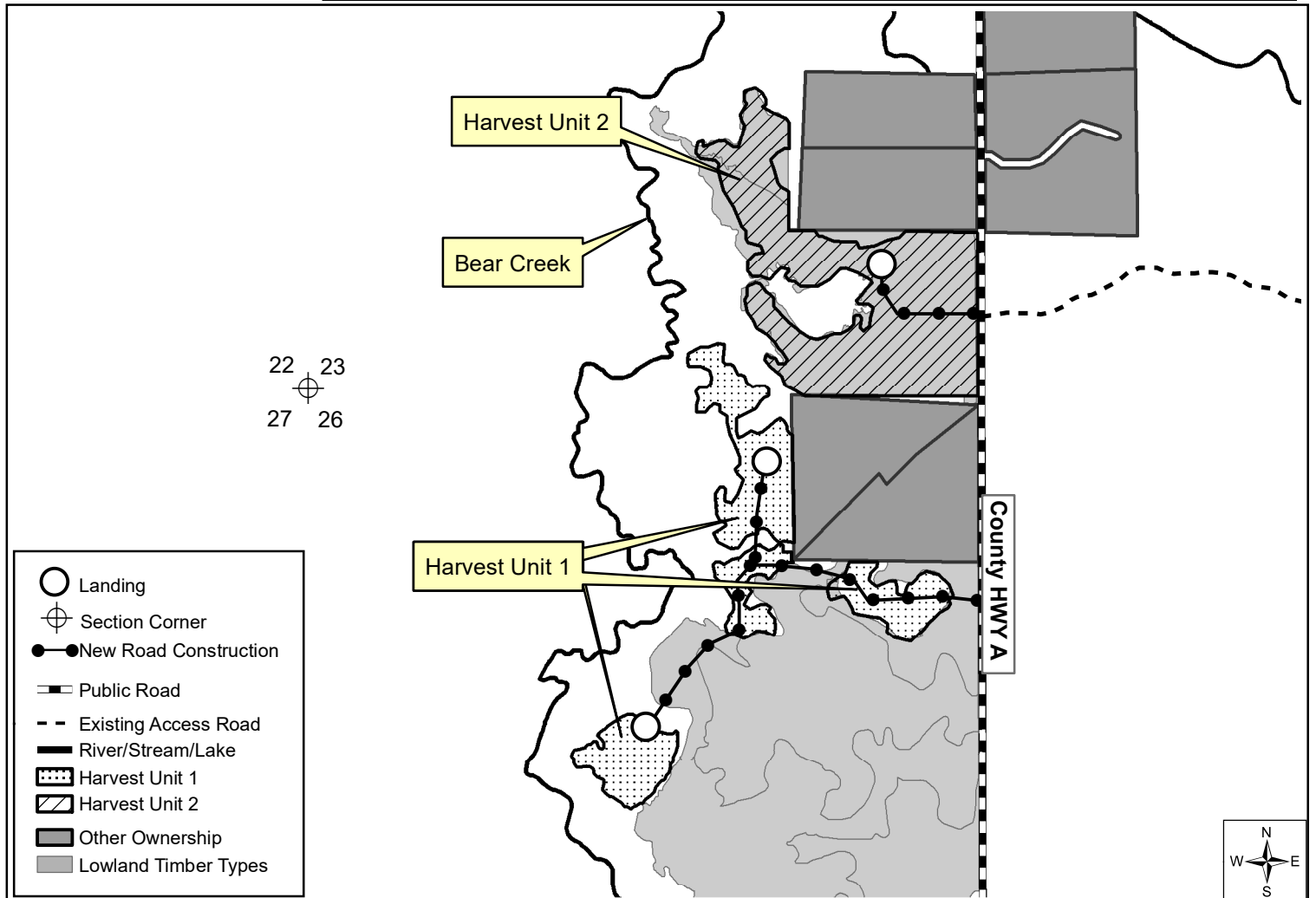

TRACT 26-20 (SPRUCETACULAR) – SUPPLEMENTAL REQUIREMENTS

The following terms and conditions supplement those provided in the Douglas County Timber Sale Contract:

A. PRESCRIPTION -

- Clear-cut harvest prescription with an estimated average residual basal area of 2ft².

B. SEASONAL RESTRICTIONS -

- All harvesting operations shall be limited to frozen ground conditions only.

C. TREES DESIGNATED FOR CUTTING -

- In harvest unit 1, fell, skid, and haul all aspen, white birch, red maple, balsam fir, and balsam poplar stems that meet the product and utilization standards as per product bid.
- In harvest unit 2, fell, skid, and haul all black spruce, tamarack, and balsam fir stems that meet the product and utilization standards as per product bid.

D. TREES DESIGNATED FOR LEAVING -

- In both harvest units, reserve and leave undamaged all white pine, white spruce, red oak, elm, cherry, and ironwood stems.

E. HARVEST AND OPERATIONAL REQUIREMENTS -

- "Slashing Maintenance" is required for harvest unit 1.
- In both harvest units, all harvesting operations shall be limited to short-wood/cut-to-length operations only. Sheared stems shall be limbed, topped, and processed at the stump prior to product forwarding.
- Three landing locations are permitted as designated. Alternative landing locations can be discussed during the pre-operations meeting.
- Access road system may be utilized for product decking.

F. ACCESS AND ROADS -

- The total length of the access road system is approximately 5,280 feet and will require "Class 4" new construction.
- Significant portions will require freeze down before use.

G. OTHER -

- 3-year term of contract.
- New road construction off County Highway A may require a driveway permit issued by the County Highway Department. Securing this permit shall be the responsibility of the County and may require installation of a culvert and gravel approach. Contact the Sale Administrator for further information.
- All access roads and landing locations requiring new construction are not marked in the field. The Sale Administrator will locate, identify, and flag these in during the pre-operations meeting.