

TIMBER SALE MAP



Douglas County Forestry Department
 9182 East Hughes Avenue
 P.O. Box 211
 Solon Springs, WI 54873
 Phone (715) 378-2219, Fax (715) 378-2807

TRACT NUMBER: **42-19**

SALE NUMBER:

Prepared By: Jim Latvala (WDNR) Legal: Sec 18 T43N - R12W , Sec 13 T43N-R13W
 Sale Name: Lost Lake Town: Wascott Topography: Flat
 Scale Method: Ticket Scale Acres: 65 Harvest Units: 4 Soils: Sand
 Contract Period: 2 Years Map Scale: 4" = 1 mile Season: All-Season

-- See the Douglas County Timber Sale Contract and reverse side for terms and conditions. --

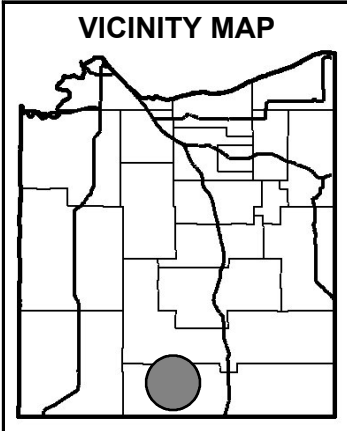

SPECIES, PRICE & ESTIMATED VOLUME INFORMATION				
SPECIES	4" ROUNDWOOD (CORDS)	WHOLE-TREE (CORDS)	SAWLOGS (MBF)	MINIMUM TOTAL SPECIES PRICE
Red Pine	185	XXX	XXX	\$4,107.00
Scrub Oak	350	XXX	XXX	\$2,905.00
TOTALS	535	XXX	XXX	\$7,012.00

The Red Pine volume contains approximately 99% Red Pine and 1% Jack Pine. The Scrub Oak volume contains approximately 77% Scrub Oak and 23% Aspen. The red pine volume in harvest unit one contains a percentage of sawlog and pole material.

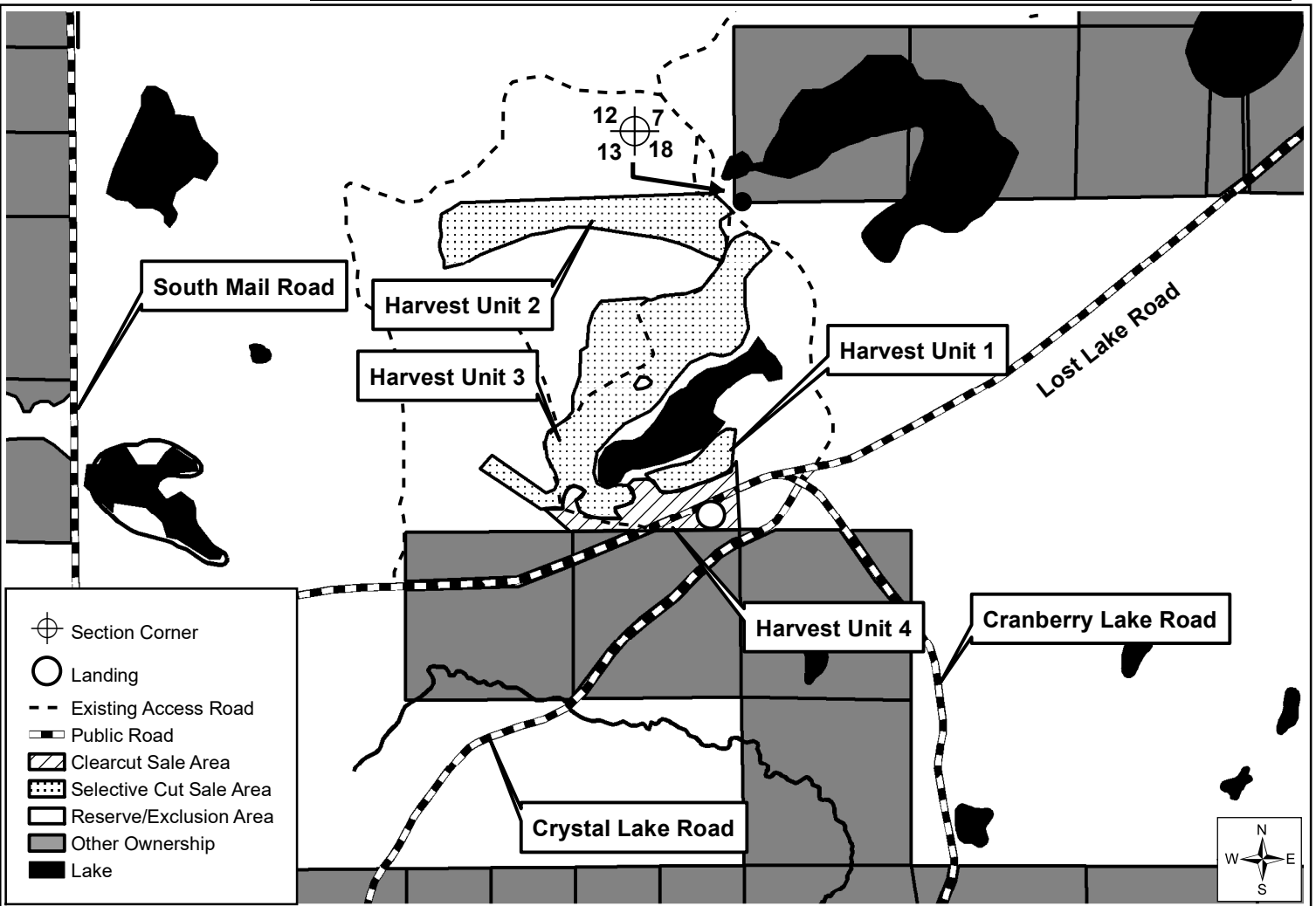

TRACT 42-19 (LOST LAKE) – SUPPLEMENTAL REQUIREMENTS

The following terms and conditions supplement those provided in the Douglas County Timber Sale Contract:

A. PRESCRIPTION -

- Harvest unit 1 has a sanitation harvest prescription with an estimated average residual basal area of 70ft².
- Harvest units 2 has a 1st entry improvement thinning harvest prescription with an estimated average residual basal area of 80ft².
- Harvest units 3 has a 1st entry improvement thinning harvest prescription with an estimated average residual basal area of 60ft².
- Harvest unit 4 has a clear-cut harvest prescription with an estimated average residual basal area of 8ft².

B. SEASONAL RESTRICTIONS -

- All harvesting operations are not restricted by season or time of the year.

C. TREES DESIGNATED FOR CUTTING -

- In harvest unit 1, fell, skid, and haul all jack pine, aspen, scrub oak, and all orange marked stems that meet the product and utilization standards as per product bid.
- In harvest unit 2, in every third row, fell all red pine, jack pine, aspen, and scrub oak stems. Skid and haul all felled stems that meet the product and utilization standards as per product bid. The Sale Administrator will describe the every third row harvest system and designate rows to be harvested during the pre-operations meeting.
- In harvest unit 3, fell all aspen, scrub oak, and all orange marked stems. Skid and haul all felled stems that meet the product and utilization standards as per product bid. Select non-merchantable, operational trees will require removal to accommodate equipment. This will be discussed by the Sale Administrator during the pre-operations meeting.
- In harvest unit 4, fell, skid, and haul all jack pine, aspen, scrub oak, and orange marked stems that meet the product and utilization standards as per product bid.

D. TREES DESIGNATED FOR LEAVING -

- In harvest unit 1, reserve and leave undamaged all non-marked stems.
- In harvest unit 2, reserve and leave undamaged all species stems in residual rows.
- In harvest unit 3, reserve and leave undamaged all non-marked red pine and jack pine stems.
- In harvest unit 4, reserve and leave undamaged all white pine and non-marked red pine stems.

E. HARVEST AND OPERATIONAL REQUIREMENTS -

- In harvest unit 1, sheared stems shall be limbed and topped at the stump prior to product skidding or forwarding.
- In harvest units 2, 3, and 4, all harvesting operations shall be limited to short-wood/cut-to-length operations only. Sheared stems shall be limbed, topped, and processed at the stump prior to product forwarding
- One landing location is permitted as designated.
- Access road system shall be utilized for product decking.
- In harvest unit 4, "Slashing Maintenance".

F. ACCESS AND ROADS -

- No new access roads shall be constructed.
- The total length of the existing access road system is approximately 6,000 feet.
- Portions may require minimal "Class 3" reconstruction before use.

G. OTHER -

-